

REACH RODS

Reach Rod with integral square STRAIGHT shank and threaded for specified Handwheel.

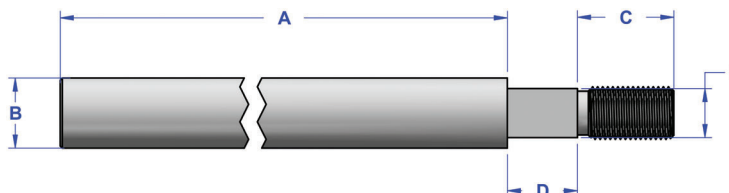

Reach Rod with integral square TAPER shank and threaded for specified Handwheel.

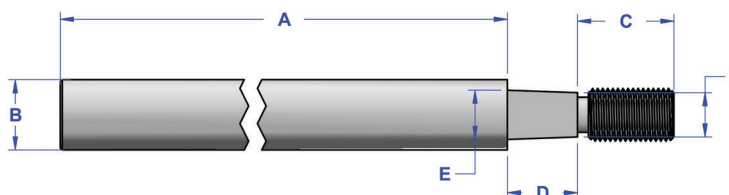

Reach Rod with integral square STRAIGHT shank Handwheel drilled and tapped for mounting bolt.

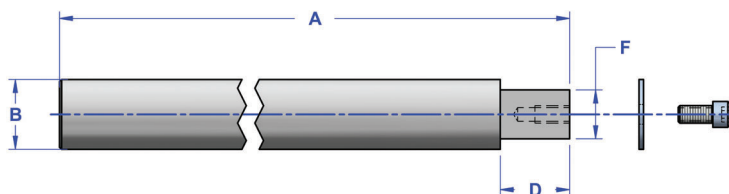

Reach Rod with integral square TAPER shank Handwheel drilled and tapped for mounting bolt.

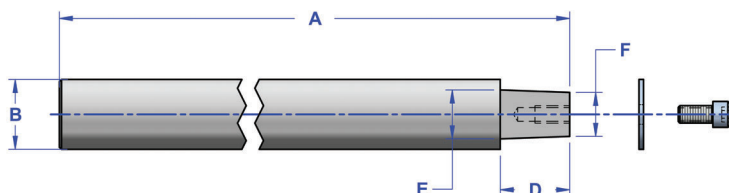

ERL Reach Rods are all manufactured from 300 series, corrosion resistant, stainless steel for extended service life under all conditions. Full length Reach Rods can be provided, as well as, the easier to install, coupled upper and lower Reach Rods. The Handwheel adapter can be machined integral to the Reach Rod or you can use one of ERL's Stem Adapters if you are looking for the ultimate in installation flexibility. Refer to the drawings above and the Ordering Information Table below when ordering. Take care to preserve the reach rods smooth finish in way of the stuffing box.

ORDERING INFORMATION TABLE

Reach Rod Style	A Length	B Diameter	C Thread Length	D Flat Length	Flat Dimension	
					E Big End	F Small End
Square					n/a	
Taper						